



**WARNINGS**



**PLEASE READ THESE INSTRUCTIONS CAREFULLY PRIOR TO INSTALLATION / MAINTENANCE**

- If a fitting is found to be damaged, cease use immediately.
- Contains batteries – avoid extreme heat/ fire and recycle sensibly – check with your local authority or retailer for further advice.
- The unit may get warm whilst on for a period of time.
- Always take care when installing your solar light, especially when mounting it in high places.
- Secure all cabling, leaving slightly slack.
- All connections should be made as watertight as possible to avoid electrical shortage.
- Do not modify this fitting or it may void any warranty and result in an unsafe product. Always consult the manufacturer.
- Ensure all mounting instructions are followed.
- Ensure the fitting is mounted out of range of head height to avoid injury.
- The unit will not charge correctly if the panel is behind glass or in artificial light.

**SPECIFICATIONS**

**Wattage:** 200W // 300W // 400W

**LEDs:** In-built Caiting SMD 2835 LEDs (60° Beam Angle) 200W = 126pcs / 300W = 198pcs, 400W = 198pcs

**Colour Temperature:** 6000K (Daylight)

**Lumen Output:** 2600lm // 3800lm // 4800lm

**LED Life Expectancy:** 20,000 hours (approx.)

**Function:** Variable – see remote control settings

**Light Sensor LUX Level:** 5 lux (approx.)

**IP Rating:** IP65

**Battery Type:** LiFePO4 (Lithium)

200W (4pc) = 3.2V 20AH, 300W (6 pcs) = 3.2V 30AH, 400W (8 pcs) = 3.2V 40AH

**Battery Charge Time:** 4-6 hours (approx.)

**Solar Panel:** Monocrystalline 200W = 5V 20W, 300W = 5V 30W, 400W = 5V 40W

**Max Illumination Time at Full Charge:** 12-14 hours (varies by function, location, weather and seasonal light conditions)

**Cable Length:** 2m (approx.) plug & play

**Materials:** Die Cast Aluminium, Steel, Tempered Glass

**Mounting:** Surface mount (adjustable brackets) – compatible with pole mounting clamps

**Recommended Mounting Height:** 3-5m

**Remote Control:** Infrared (up to 12m range) – requires 2 x AAA batteries (not included)

**Working Temperature:** -10°C to 40°C

**Included:** Flood Light, Solar Panel, 2x Bracket & Fixings, 1 x socket wrench, Remote Control, 4x Expanding Anchor Bolts

**Accessories (optional):** 4m extension cable available (plug & play), 76mm column bracket, 60mm column bracket

**UK REGISTERED DESIGN:** 200W: 6450829 300W: 6450828 400W: 6450827



**CLEANING & MAINTENANCE:**

Occasional cleaning and care are recommended for this product. Wipe with a soft, slightly damp cloth to remove any surface dirt. To maintain efficiency, specifically clean the solar panel and flood light lens on a regular basis. Also, keep the solar panel free of debris and snow to prevent reduced battery life or malfunction. Do not use abrasive cleaners or a lot of water as this could damage the fitting. Please refer to our website for more information on the best way to clean different materials.

**RETURNS:**

**If purchased from a 3<sup>rd</sup> party, please contact your supplier. If purchased direct, contact us by phone or email:**  
Lumena Lights Ltd, Centre 33 Long March, Daventry, NN11 4NR Tel: +44 1327 871161 Email: [sales@lumenalights.com](mailto:sales@lumenalights.com)

**Our full returns policy is available on our website.**

Waste Electrical Products should not be disposed of with household waste. Please check with your local authority or contact us for more information. Please recycle packaging whenever possible.

**Producer Registration Numbers: WEE/KC3440XY / BPRN0843**

Full product range & more information: [www.lumenalights.com](http://www.lumenalights.com)

## INSTALLATION:

The Heliosol is designed to be mounted on any flat surface or column, with the solar panel located up to approximately 2m away to ensure maximum light exposure. The higher the light is mounted, the larger the illuminated area with slightly less intensity. A 4m extension cable is available to extend the distance between solar panel & flood light – this may increase the charging time slightly.

**Location** – It is important that the installation location is carefully considered, avoiding shady areas. The best position for the solar panel is south facing; however, it will still charge the battery when facing in other directions, especially when in full sunshine. Ensure there are no other lights which could interfere with the panel, imitating daylight. Always mount the solar panel higher than the floodlight to avoid light interference.

### SURFACE MOUNTING

1. Experiment with desired position of both the flood light and solar panel, ensuring there is enough slack in the cable to safely hook up when they are mounted in the desired location in prime charging position. It is recommended that cables are connected to ensure there is enough cable (with slack) between the panel and unit before final mounting.
2. Once happy with the positioning, mark the mounting holes of each bracket in the desired location. See diagram below and “to scale” template attached.
3. Drill out the holes and use relevant screws / plugs for the mounting surface and secure both the solar panel (white) and floodlight (black) brackets in place. 4x M10 anchor bolts supplied.
4. Attach the white solar panel bracket to the solar panel using the 2x M5 hexagonal bolts, 4x flat washers and 2x locking nuts (see diagram). Do not overtighten to allow adjustment. Note: the screw head and smaller flat washer should be located on the inside of the panel, with the larger flat washer and locking nut on the outside of the panel. Allen key supplied. 8mm spanner required.
5. Attach the black floodlight bracket to the floodlight using the 2x M8 hexagonal bolts, flat washers and lock washers (see diagram). Do not overtighten to allow adjustment after installation. 14mm spanner required.
6. Adjust the angle of the solar panel & flood light, as desired, and tighten into position with the socket wrench / spanners used previously. Adjust solar panel to approx. 45 degrees upwards for maximum charge effectiveness.
7. Connect the floodlight and solar panel cables (see below). Check the waterproof cable connector(s) are secure.

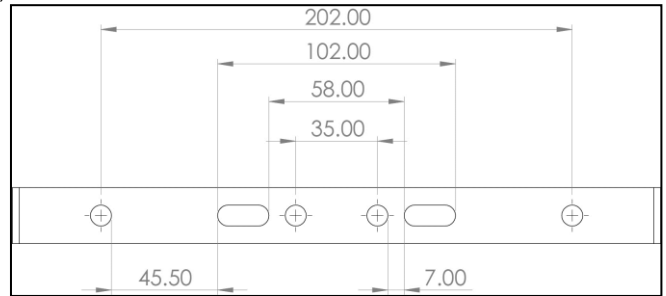
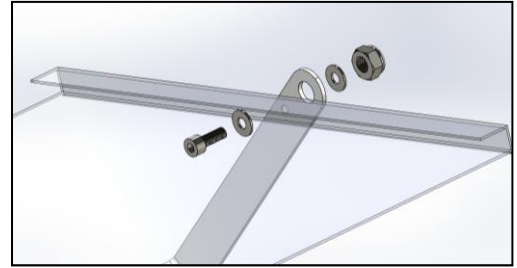

### COLUMN MOUNTING

1. Follow steps 4 and 5 above.
2. Attach the relevant 76mm or 60mm brackets to both the floodlight bracket and solar panel bracket as per the instructions.
3. Mount the bracket securely onto the column with the solar panel as high as possible.
4. Continue with steps 6 and 7 above.

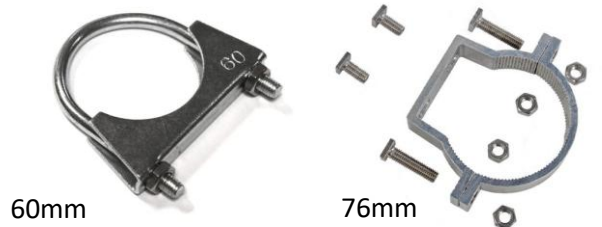

## CONNECTIONS:

The Heliosol uses a simple, modular, plug & play system (DC). If the flexible connector has been misfigured in transit, simply massage into shape and round off with the cap.

To connect together each waterproof connector:

1. Locate the top notch and groove (see fig. A).
2. Firmly push together both connectors, aligning the top notch and groove (in point 1) and the 2 pins (see Fig. B).
3. Ensure the red o-ring is present (see Fig. B).
4. Secure the connectors with the screw cap (turning clockwise) to create a watertight connection (see Fig. C).
5. Turn on the system via the remote control to test all fittings are working as expected. Turn the power back off until fully installed. Note: in daylight the solar panel will need to be covered to mimic darkness when plugged into the floodlight to enable testing.

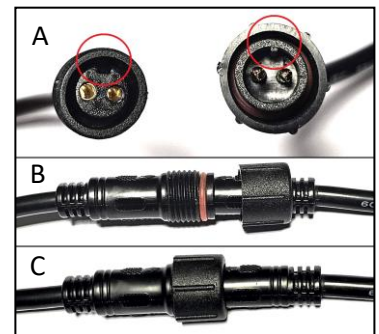

### IMPORTANT:

If buried or laid on a muddy surface, cable should be placed inside conduit or piping to protect from water-logging, damage and chemicals found in soil. If this method is not followed, cable warranty may be void. Cables can also be hooked up on fences safely, however protective sleeving is still recommended.

Full product range & more information: [www.lumenalights.com](http://www.lumenalights.com)

## CHARGING:

**FIRST CHARGE:** Although the battery has been charged by the manufacturer, the battery level will have decreased during storage. It is recommended to charge for 12 hours prior to first use in the “permanent off” setting. After 12 hours of charging set the desired function. To check if the fitting is turned on during daylight, cover the solar panel completely with a sheet. The light will illuminate if turned on. The floodlight will not remain on during daylight.



After 48 hours of no charging activity the light will enter sleep mode. Connect the floodlight to the panel and select a function to awaken. Charging may be required.

### THE FLOODLIGHT MUST BE PLUGGED INTO THE PANEL TO CHARGE AS THE BATTERY IS LOCATED WITHIN THE FLOODLIGHT UNIT

## REMOTE CONTROL SETTINGS:

Before use, insert 2x AAA batteries into the remote control (not supplied). Remote control can command more than one fitting in range. Infra-red sensor is located in the flood light lens. For first time use, select the AUTO function.



KEY	FUNCTION	DESCRIPTION
ON	ON	Turns light on with the last selected time control mode.
OFF	OFF	The light will be turned off for one night only.
OFF (Hold for 5 Secs)	Permanent OFF	When OFF button is held down, the unit will still charge but the floodlight will not turn on.
	100% Brightness	Highest brightness mode.
	Dim to 20% Brightness	Light is on at 20% brightness. This mode is not remembered and will reset to 100% the next night.
2H	2 Hours Time Mode	Light Automatically comes on at dusk, then remains on for 2 hours.
4H	4 Hours Time Mode	Light Automatically comes on at dusk, then remains on for 4 hours.
6H	6 Hours Time Mode	Light Automatically comes on at dusk, then remains on for 6 hours.
AUTO	DUSK TO DAWN (<12 HOURS)	Light Automatically comes on at dusk, then remains on until dawn (max 12 hours).

## INDICATOR LIGHTS:

**Green Lights:** Indicate current charge capacity in 25% increments  
**Red Light:** Flash every 1 second when charging / Quick flash every 2 seconds when discharging (if didn't reach 100% during last charge cycle) / Off during discharge (if 100% reached during last charge cycle)



## STORAGE:

To turn off permanently / enter sleep mode, hold down the off button for 5 seconds (the light will turn off, flash on twice and then turn off permanently). Max. 6 months storage when charged – recharge and cycle will be required periodically to prevent damage to battery over long periods of time.

When the “forced off” function is selected, or if the floodlight is used without being connected to the solar panel, after 48 hours of no charging activity the light will enter Sleep Mode at a current of 5uA. To reset, connect the floodlight to the panel and select your desired function on the remote.

Full product range & more information: [www.lumenalights.com](http://www.lumenalights.com)